

CONTRACTORS SHALL VERIFY JOB DIMENSIONS BEFORE ANY JOB COMMENCES. ALL SHOP DRAWINGS SHALL BE SUBMITTED TO THE SUPERINTENDENT AND MANUFACTURER SHALL NOT COMMENCE FROM THE RETURN OF DIMENSIONS SHOP DRAWINGS ISSUED BY THE CONSULTANT. FIGURED DIMENSIONS SHALL TAKE PRECEDENCE OVER SCALED. THIS DRAWING SHALL BE READ IN CONJUNCTION WITH ALL RELATED CONTRACT SPECIFICATIONS AND DRAWINGS COPYRIGHT OF THIS DRAWING IS VESTED IN HANDLE.

General Notes

REFER ARCHITECTURAL DRAWINGS:

- FACADE SETOUT AR1502-AR1507
- PRECAST SETOUT AR1512-AR1517
- SCREEN SETOUT AR1502-AR1557
- SCREEN DETAILS AR6500-AR6554

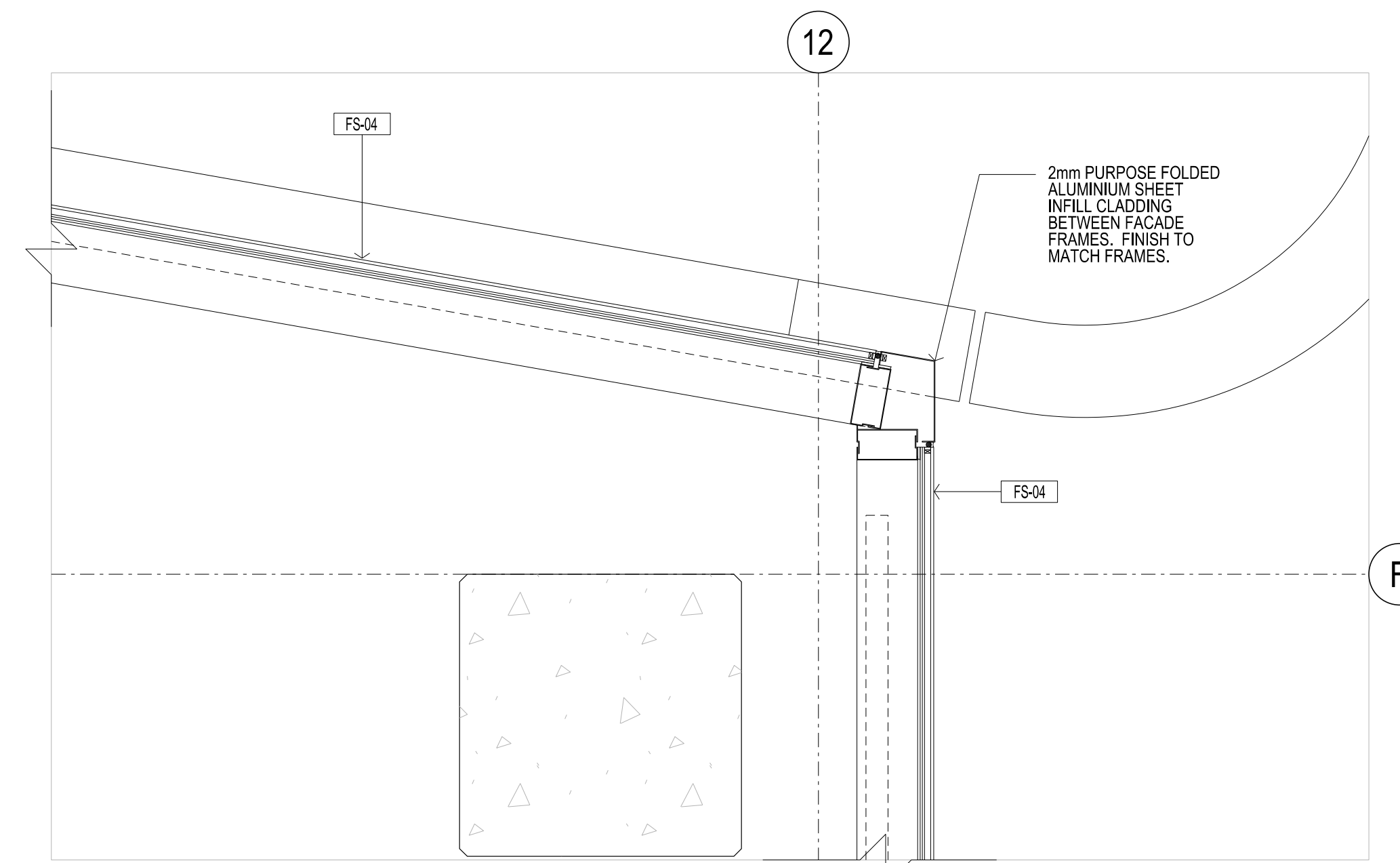

01 PLAN DETAIL - L01
1203 SCALE 1:10

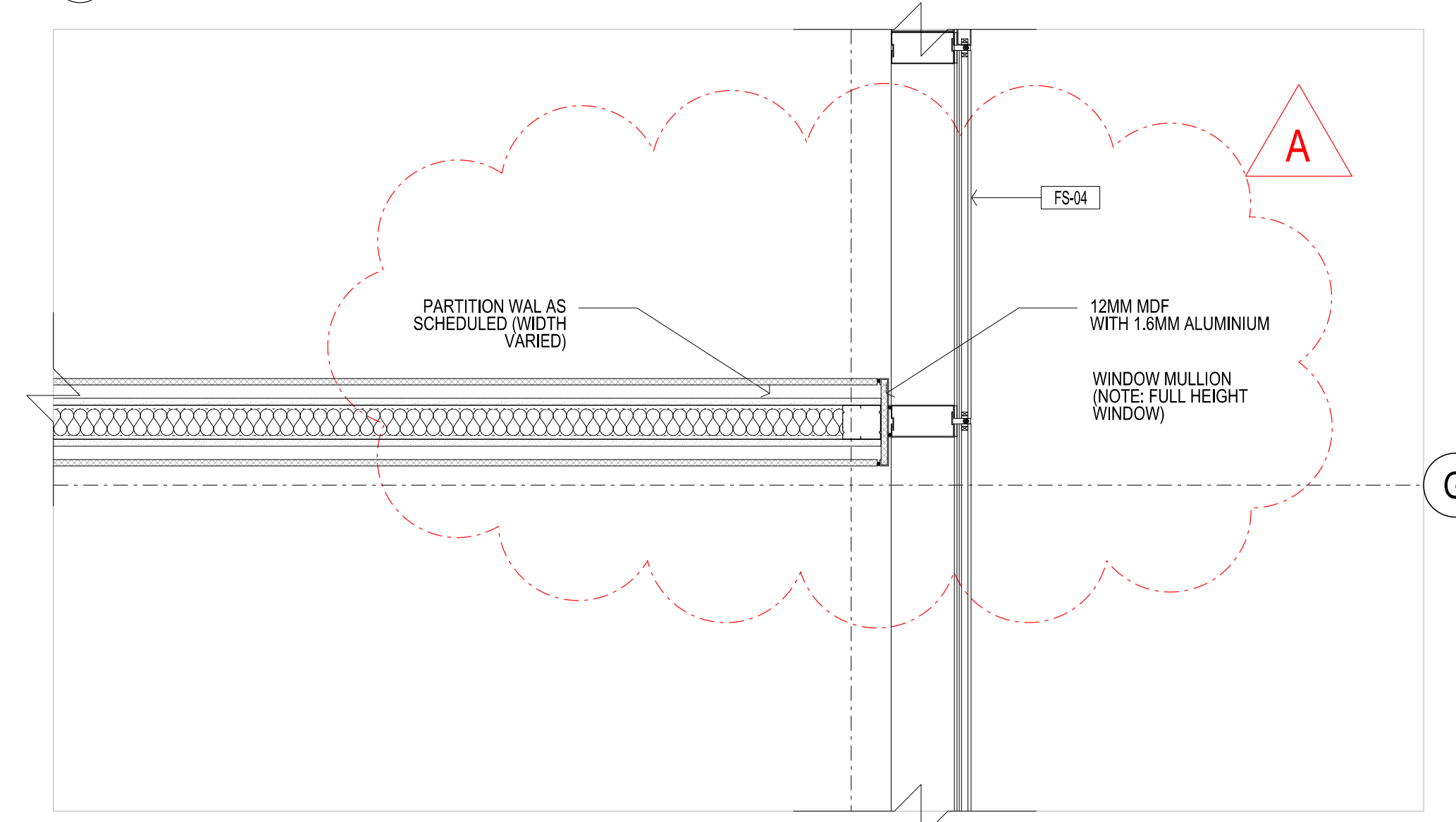

02 PLAN DETAIL - L01
1203 SCALE 1:10

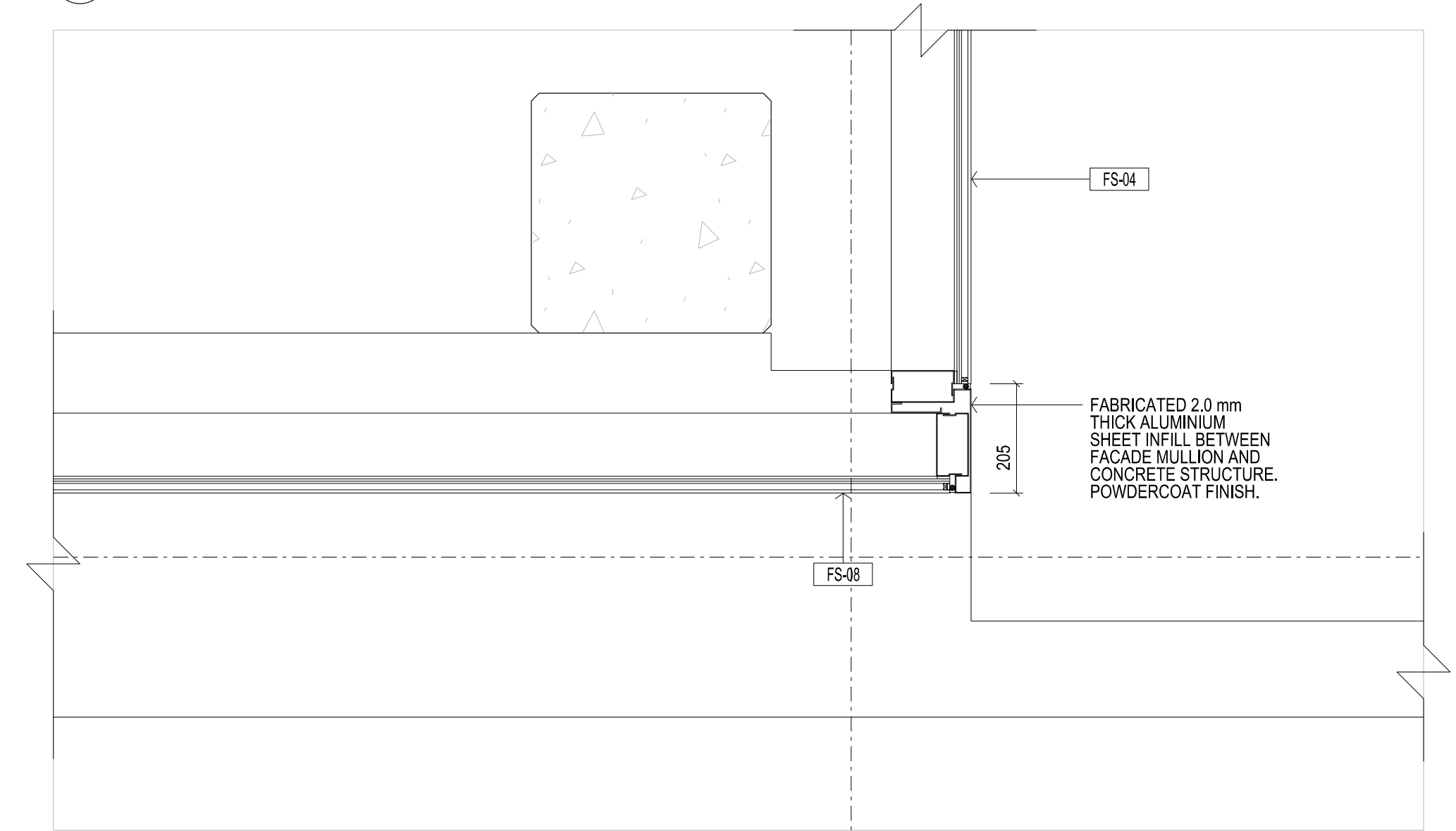

03 PLAN DETAIL - L01
1203 SCALE 1:10

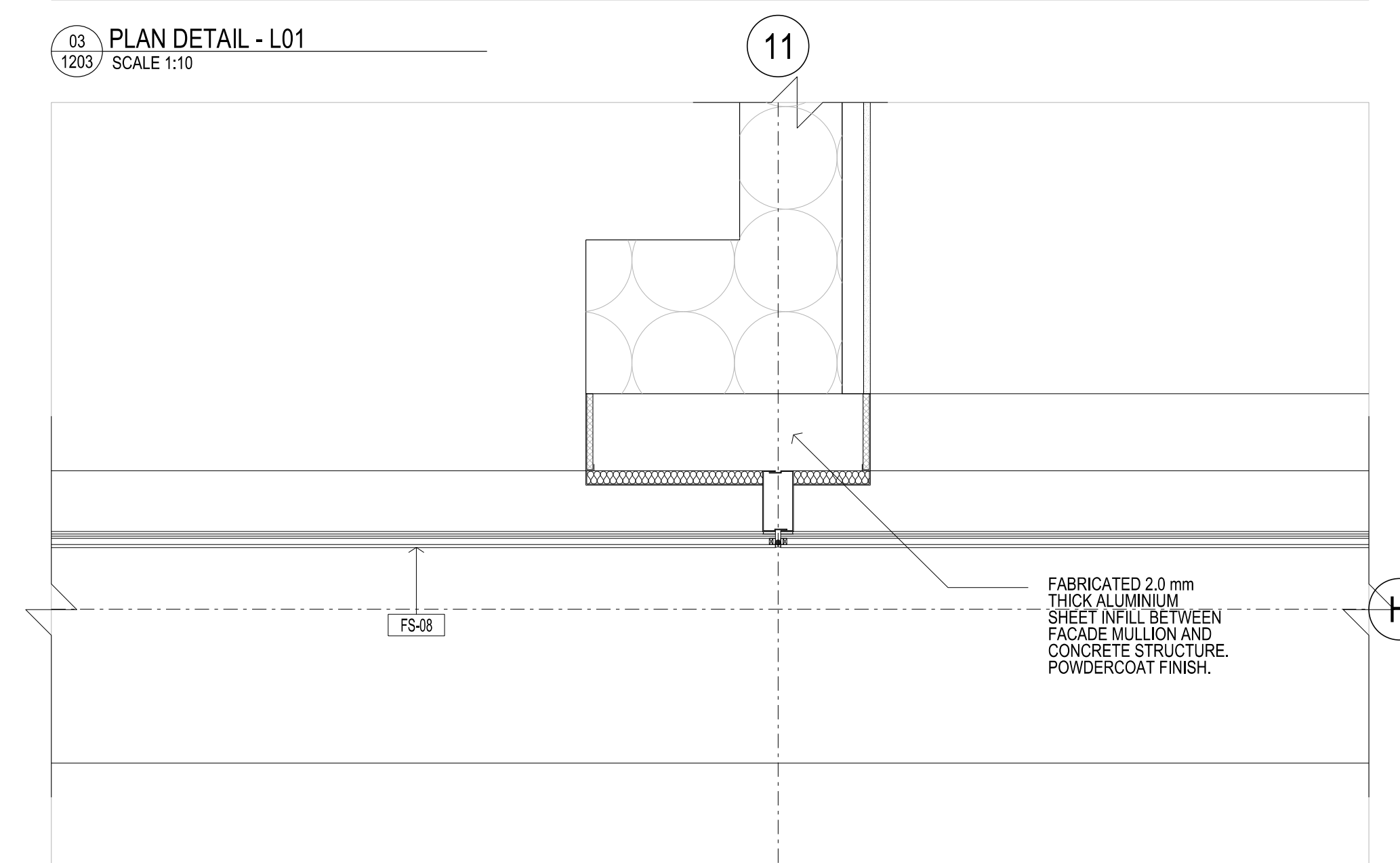

04 PLAN DETAIL - L01
1203 SCALE 1:10

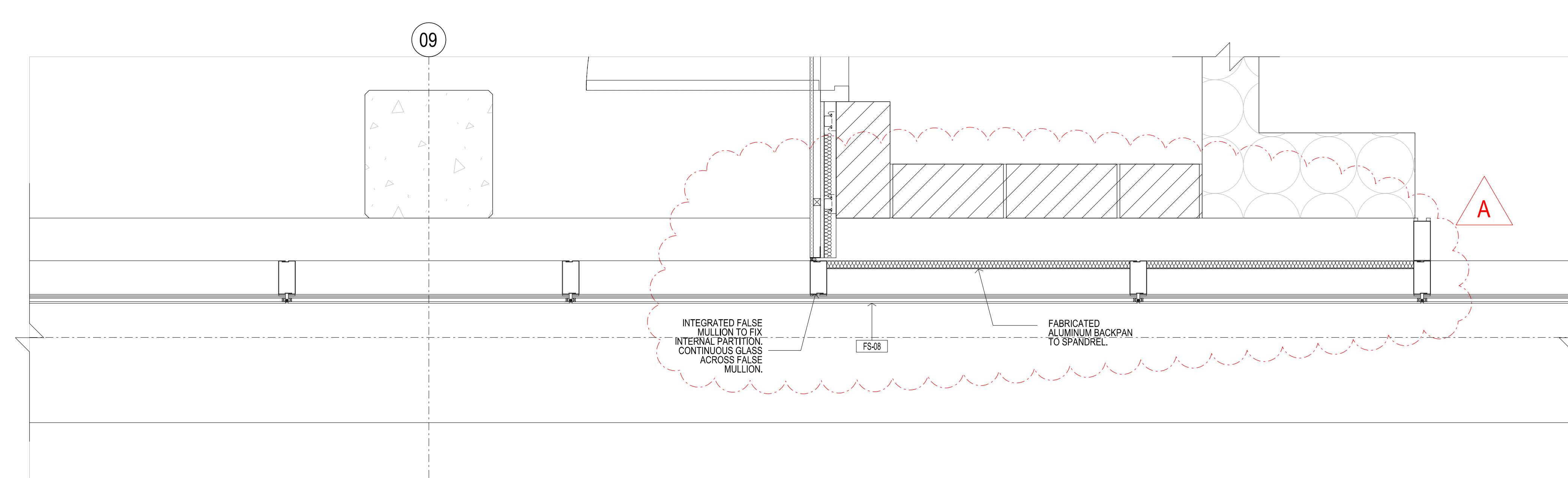

05 PLAN DETAIL - L01
1203 SCALE 1:10

Rev	Issue	Revision Description	Amd	Date
A	SG	PLASTERBOARD PACKAGE	-	18.09.13
		REFERENCE DWG CHANGE FROM 1500-1200'S		
05	SG	TENDER ISSUE	-	12.04.13
04	SG	100% CD - TENDER ISSUE	-	07.08.12
03	SG	90% CD ISSUE	-	10.08.12
02	SG	75% CD ISSUE	-	13.07.12
01	SG	50% CD ISSUE	-	08.08.12



NADAAA
 NADAAA
 1520 Washington Street No.2 Boston Massachusetts 02118 USA
 Telephone +1 617 442 8232 Facsimile +1 688 442 1417 Email nad@nadaaa.com

John Wardle Architects
 25 Rokeby Street, Collingwood, Victoria 3066 Australia
 Tel : +61 3 8662 0400 www.johnwardlearchitects.com
 © 2012 John Wardle Architects ABN 83 006 814 268

Client **University of Melbourne Parkville Campus**
 Project **Faculty of Architecture Building and Planning**
 Title **PLAN DETAILS**

Project No.	0913	Scale	1:10 @ A0 1:20 @ A2
Drawing No.	AR6007	Revision	A
Date	Dec 2011	Dwn	-
Co-Ord	-	Chk	-

FILENAME - \$FILES
FOR CONSTRUCTION